

PL201.01 CBN-Schleifstifte Typ 50 mit Stahl-Schaft

PL201.02 Diamant-Schleifstifte Typ 50 mit Stahl-Schaft

PL201.03 CBN-Schleifstifte Typ 51 mit Stahl-Schaft

PL201.04 Diamant-Schleifstifte Typ 51 mit Stahl-Schaft



PL201.05 CBN-Schleifstifte Typ 55 mit Hartmetall-Schaft

PL201.06 Diamant-Schleifstifte Typ 55 mit Hartmetall-Schaft

Andere Formen und Innenschleifscheiben auf Anfrage

Auf unserer Webseite finden Sie immer die aktuellste Version unserer Preislisten.
Scannen Sie den QR-Code um direkt dorthin zu gelangen.



CBN-Schleifstifte Typ 50 mit Stahl-Schaft

Abmessungen in mm
PL201.01

WMC Produktcode	Korn	Kopf-Ø D	Länge T	Schaft-Ø S	Länge L1	Länge L4	Preis pro Stück (CHF)				
							ab 1	ab 10	ab 25	ab 50	ab 100
IF5000502B91	B91	Ø 0.5	2	Ø 3.0	40	6	17.80	16.05	15.15	14.70	14.25
IF5000602B91	B91	Ø 0.6	2	Ø 3.0	40	7	17.80	16.05	15.15	14.70	14.25
IF5000604B91	B91	Ø 0.6	4	Ø 3.0	40	5	17.80	16.05	15.15	14.70	14.25
IF5000702B91	B91	Ø 0.7	2	Ø 3.0	40	7	17.80	16.05	15.15	14.70	14.25
IF5000702B126	B126	Ø 0.7	2	Ø 3.0	40	7	17.80	16.05	15.15	14.70	14.25
IF5000702B151	B151	Ø 0.7	2	Ø 3.0	40	7	17.80	16.05	15.15	14.70	14.25
IF5000704B91	B91	Ø 0.7	4	Ø 3.0	40	5	17.80	16.05	15.15	14.70	14.25
IF5000704B126	B126	Ø 0.7	4	Ø 3.0	40	5	17.80	16.05	15.15	14.70	14.25
IF5000704B151	B151	Ø 0.7	4	Ø 3.0	40	5	17.80	16.05	15.15	14.70	14.25
IF5000802B91	B91	Ø 0.8	2	Ø 3.0	40	7	17.80	16.05	15.15	14.70	14.25
IF5000802B126	B126	Ø 0.8	2	Ø 3.0	40	7	17.80	16.05	15.15	14.70	14.25
IF5000802B151	B151	Ø 0.8	2	Ø 3.0	40	7	17.80	16.05	15.15	14.70	14.25
IF5000804B91	B91	Ø 0.8	4	Ø 3.0	40	5	17.80	16.05	15.15	14.70	14.25
IF5000804B126	B126	Ø 0.8	4	Ø 3.0	40	5	17.80	16.05	15.15	14.70	14.25
IF5000804B151	B151	Ø 0.8	4	Ø 3.0	40	5	17.80	16.05	15.15	14.70	14.25
IF5000904B91	B91	Ø 0.9	4	Ø 3.0	40	6	14.75	13.30	12.55	12.20	11.80
IF5000904B126	B126	Ø 0.9	4	Ø 3.0	40	6	15.30	13.80	13.05	12.65	12.25
IF5000904B151	B151	Ø 0.9	4	Ø 3.0	40	6	15.65	14.10	13.35	12.95	12.55
IF5001004B91	B91	Ø 1.0	4	Ø 3.0	40	6	13.30	12.00	11.35	11.00	10.65
IF5001004B126	B126	Ø 1.0	4	Ø 3.0	40	6	13.70	12.35	11.65	11.35	11.00
IF5001004B151	B151	Ø 1.0	4	Ø 3.0	40	6	13.85	12.50	11.80	11.45	11.10
IF5001204B91	B91	Ø 1.2	4	Ø 3.0	40	8	13.30	12.00	11.35	11.00	10.65
IF5001204B126	B126	Ø 1.2	4	Ø 3.0	40	8	13.70	12.35	11.65	11.35	11.00
IF5001204B151	B151	Ø 1.2	4	Ø 3.0	40	8	14.05	12.65	11.95	11.60	11.25
IF5001504B91	B91	Ø 1.5	4	Ø 3.0	40	10	13.50	12.15	11.50	11.15	10.80
IF5001504B126	B126	Ø 1.5	4	Ø 3.0	40	10	13.85	12.50	11.80	11.45	11.10
IF5001504B151	B151	Ø 1.5	4	Ø 3.0	40	10	14.05	12.65	11.95	11.60	11.25
IF5001704B91	B91	Ø 1.7	4	Ø 3.0	40	10	13.50	12.15	11.50	11.15	10.80
IF5001704B126	B126	Ø 1.7	4	Ø 3.0	40	10	13.85	12.50	11.80	11.45	11.10
IF5001704B151	B151	Ø 1.7	4	Ø 3.0	40	10	14.20	12.80	12.10	11.75	11.40
IF5002004B91	B91	Ø 2.0	4	Ø 3.0	40	12	13.50	12.15	11.50	11.15	10.80
IF5002004B126	B126	Ø 2.0	4	Ø 3.0	40	12	13.85	12.50	11.80	11.45	11.10
IF5002004B151	B151	Ø 2.0	4	Ø 3.0	40	12	14.20	12.80	12.10	11.75	11.40
IF5002504B91	B91	Ø 2.5	4	Ø 3.0	40	12	13.70	12.35	11.65	11.35	11.00
IF5002504B126	B126	Ø 2.5	4	Ø 3.0	40	12	14.05	12.65	11.95	11.60	11.25

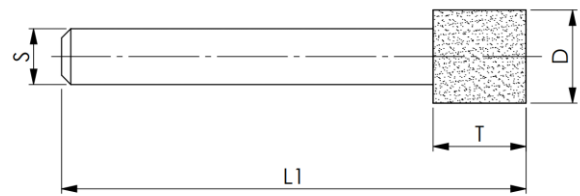
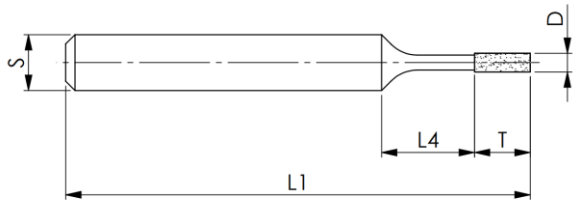

CBN-Schleifstifte Typ 50 mit Stahl-Schaft

Abmessungen in mm
PL201.01

WMC Produktcode	Korn	Kopf-Ø D	Länge T	Schaft-Ø S	Länge L1	Länge L4	Preis pro Stück (CHF)				
							ab 1	ab 10	ab 25	ab 50	ab 100
IF5002504B151	B151	Ø 2.5	4	Ø 3.0	40	12	14.40	13.00	12.25	11.90	11.55
IF5003005B91	B91	Ø 3.0	5	Ø 3.0	40	15	13.70	12.35	11.65	11.35	11.00
IF5003005B126	B126	Ø 3.0	5	Ø 3.0	40	15	14.20	12.80	12.10	11.75	11.40
IF5003005B151	B151	Ø 3.0	5	Ø 3.0	40	15	14.60	13.15	12.45	12.05	11.70
IF5003505B91	B91	Ø 3.5	5	Ø 3.0	50		16.40	14.80	13.95	13.55	13.15
IF5003505B126	B126	Ø 3.5	5	Ø 3.0	50		16.90	15.25	14.40	13.95	13.55
IF5003505B151	B151	Ø 3.5	5	Ø 3.0	50		17.30	15.60	14.75	14.30	13.85
IF5004005B91	B91	Ø 4.0	5	Ø 3.0	50		17.30	15.60	14.75	14.30	13.85
IF5004005B126	B126	Ø 4.0	5	Ø 3.0	50		18.55	16.70	15.80	15.35	14.85
IF5004005B151	B151	Ø 4.0	5	Ø 3.0	50		19.10	17.20	16.25	15.80	15.30
IF5004005B181	B181	Ø 4.0	5	Ø 3.0	50		23.20	20.90	19.75	19.15	18.60
IF5004005B252	B252	Ø 4.0	5	Ø 3.0	50		27.00	24.30	22.95	22.30	21.60
IF5004505B91	B91	Ø 4.5	5	Ø 3.0	50		18.70	16.85	15.90	15.45	15.00
IF5004505B126	B126	Ø 4.5	5	Ø 3.0	50		19.60	17.65	16.70	16.20	15.70
IF5004505B151	B151	Ø 4.5	5	Ø 3.0	50		20.15	18.15	17.15	16.65	16.15
IF5004505B181	B181	Ø 4.5	5	Ø 3.0	50		24.30	21.90	20.70	20.05	19.45
IF5004505B252	B252	Ø 4.5	5	Ø 3.0	50		28.60	25.75	24.35	23.60	22.90
IF5005007B91	B91	Ø 5.0	7	Ø 3.0	50		19.25	17.35	16.40	15.90	15.40
IF5005007B126	B126	Ø 5.0	7	Ø 3.0	50		20.35	18.35	17.30	16.80	16.30
IF5005007B151	B151	Ø 5.0	7	Ø 3.0	50		21.05	18.95	17.90	17.40	16.85
IF5005007B181	B181	Ø 5.0	7	Ø 3.0	50		25.90	23.35	22.05	21.40	20.75
IF5005007B252	B252	Ø 5.0	7	Ø 3.0	50		30.05	27.05	25.55	24.80	24.05
IF5006007B91	B91	Ø 6.0	7	Ø 6.0	60	13	20.35	18.35	17.30	16.80	16.30
IF5006007B126	B126	Ø 6.0	7	Ø 6.0	60	13	21.60	19.45	18.40	17.85	17.30
IF5006007B151	B151	Ø 6.0	7	Ø 6.0	60	13	23.05	20.75	19.60	19.05	18.45
IF5006007B181	B181	Ø 6.0	7	Ø 6.0	60	13	28.45	25.65	24.20	23.50	22.80
IF5006007B252	B252	Ø 6.0	7	Ø 6.0	60	13	33.50	30.15	28.50	27.65	26.80
IF5006107B91	B91	Ø 6.0	7	Ø 6.0	80	13	21.05	18.95	17.90	17.40	16.85
IF5006107B126	B126	Ø 6.0	7	Ø 6.0	80	13	22.70	20.45	19.30	18.75	18.20
IF5006107B151	B151	Ø 6.0	7	Ø 6.0	80	13	23.75	21.40	20.20	19.60	19.00
IF5006107B181	B181	Ø 6.0	7	Ø 6.0	80	13	29.15	26.25	24.80	24.05	23.35
IF5006107B252	B252	Ø 6.0	7	Ø 6.0	80	13	34.55	31.10	29.40	28.55	27.65
IF5007008B91	B91	Ø 7.0	8	Ø 6.0	60		25.20	22.70	21.45	20.80	20.20
IF5007008B126	B126	Ø 7.0	8	Ø 6.0	60		27.00	24.30	22.95	22.30	21.60
IF5007008B151	B151	Ø 7.0	8	Ø 6.0	60		28.25	25.45	24.05	23.35	22.60
IF5007008B181	B181	Ø 7.0	8	Ø 6.0	60		35.30	31.80	30.05	29.15	28.25
IF5007008B252	B252	Ø 7.0	8	Ø 6.0	60		41.60	37.45	35.40	34.35	33.30
IF5007108B91	B91	Ø 7.0	8	Ø 6.0	80		25.55	23.00	21.75	21.10	20.45
IF5007108B126	B126	Ø 7.0	8	Ø 6.0	80		27.70	24.95	23.55	22.90	22.20
IF5007108B151	B151	Ø 7.0	8	Ø 6.0	80		28.80	25.95	24.50	23.80	23.05
IF5007108B181	B181	Ø 7.0	8	Ø 6.0	80		35.80	32.25	30.45	29.55	28.65
IF5007108B252	B252	Ø 7.0	8	Ø 6.0	80		42.30	38.10	36.00	34.90	33.85

CBN-Schleifstifte Typ 50 mit Stahl-Schaft

Abmessungen in mm
PL201.01

WMC Produktcode	Korn	Kopf-Ø D	Länge T	Schaft-Ø S	Länge L1	Länge L4	Preis pro Stück (CHF)				
							ab 1	ab 10	ab 25	ab 50	ab 100
IF5008010B91	B91	Ø 8.0	10	Ø 6.0	60		26.80	24.15	22.80	22.15	21.45
IF5008010B126	B126	Ø 8.0	10	Ø 6.0	60		28.80	25.95	24.50	23.80	23.05
IF5008010B151	B151	Ø 8.0	10	Ø 6.0	60		30.40	27.40	25.85	25.10	24.35
IF5008010B181	B181	Ø 8.0	10	Ø 6.0	60		38.15	34.35	32.45	31.50	30.55
IF5008010B252	B252	Ø 8.0	10	Ø 6.0	60		45.00	40.50	38.25	37.15	36.00
IF5008110B91	B91	Ø 8.0	10	Ø 6.0	80		27.55	24.80	23.45	22.75	22.05
IF5008110B126	B126	Ø 8.0	10	Ø 6.0	80		29.00	26.10	24.65	23.95	23.20
IF5008110B151	B151	Ø 8.0	10	Ø 6.0	80		30.60	27.55	26.05	25.25	24.50
IF5008110B181	B181	Ø 8.0	10	Ø 6.0	80		38.50	34.65	32.75	31.80	30.80
IF5008110B252	B252	Ø 8.0	10	Ø 6.0	80		45.35	40.85	38.55	37.45	36.30
IF5010010B91	B91	Ø 10.0	10	Ø 6.0	60		28.60	25.75	24.35	23.60	22.90
IF5010010B126	B126	Ø 10.0	10	Ø 6.0	60		30.60	27.55	26.05	25.25	24.50
IF5010010B151	B151	Ø 10.0	10	Ø 6.0	60		33.30	30.00	28.35	27.50	26.65
IF5010010B181	B181	Ø 10.0	10	Ø 6.0	60		41.20	37.10	35.05	34.00	33.00
IF5010010B252	B252	Ø 10.0	10	Ø 6.0	60		48.80	43.95	41.50	40.30	39.05
IF5010110B91	B91	Ø 10.0	10	Ø 6.0	80		29.00	26.10	24.65	23.95	23.20
IF5010110B126	B126	Ø 10.0	10	Ø 6.0	80		31.30	28.20	26.65	25.85	25.05
IF5010110B151	B151	Ø 10.0	10	Ø 6.0	80		33.65	30.30	28.65	27.80	26.95
IF5010110B181	B181	Ø 10.0	10	Ø 6.0	80		41.95	37.80	35.70	34.65	33.60
IF5010110B252	B252	Ø 10.0	10	Ø 6.0	80		49.30	44.40	41.95	40.70	39.45
IF5012010B91	B91	Ø 12.0	10	Ø 6.0	60		30.25	27.25	25.75	25.00	24.20
IF5012010B126	B126	Ø 12.0	10	Ø 6.0	60		33.30	30.00	28.35	27.50	26.65
IF5012010B151	B151	Ø 12.0	10	Ø 6.0	60		35.65	32.10	30.35	29.45	28.55
IF5012010B181	B181	Ø 12.0	10	Ø 6.0	60		45.90	41.35	39.05	37.90	36.75
IF5012010B252	B252	Ø 12.0	10	Ø 6.0	60		54.35	48.95	46.20	44.85	43.50
IF5012110B91	B91	Ø 12.0	10	Ø 6.0	80		31.70	28.55	26.95	26.20	25.40
IF5012110B126	B126	Ø 12.0	10	Ø 6.0	80		34.20	30.80	29.10	28.25	27.40
IF5012110B151	B151	Ø 12.0	10	Ø 6.0	80		36.35	32.75	30.90	30.00	29.10
IF5012110B181	B181	Ø 12.0	10	Ø 6.0	80		47.50	42.75	40.40	39.20	38.00
IF5012110B252	B252	Ø 12.0	10	Ø 6.0	80		56.35	50.75	47.90	46.50	45.10
IF5015010B91	B91	Ø 15.0	10	Ø 6.0	60		36.55	32.90	31.10	30.20	29.25
IF5015010B126	B126	Ø 15.0	10	Ø 6.0	60		39.95	36.00	34.00	33.00	32.00
IF5015010B151	B151	Ø 15.0	10	Ø 6.0	60		43.00	38.70	36.55	35.50	34.40
IF5015010B181	B181	Ø 15.0	10	Ø 6.0	60		54.00	48.60	45.90	44.55	43.20
IF5015010B252	B252	Ø 15.0	10	Ø 6.0	60		62.10	55.90	52.80	51.25	49.70
IF5015110B91	B91	Ø 15.0	10	Ø 6.0	80		37.60	33.85	32.00	31.05	30.10
IF5015110B126	B126	Ø 15.0	10	Ø 6.0	80		40.85	36.80	34.75	33.75	32.70
IF5015110B151	B151	Ø 15.0	10	Ø 6.0	80		43.75	39.40	37.20	36.10	35.00
IF5015110B181	B181	Ø 15.0	10	Ø 6.0	80		54.90	49.45	46.70	45.30	43.95
IF5015110B252	B252	Ø 15.0	10	Ø 6.0	80		63.55	57.20	54.05	52.45	50.85

Lieferfrist: ab Werklager 1 - 2 Arbeitswochen, Zwischenverkauf vorbehalten

Diamant-Schleifstifte Typ 50 mit Stahl-Schaft

Abmessungen in mm
PL201.02

WMC Produktcode	Korn	Kopf-Ø D	Länge T	Schaft-Ø S	Länge L1	Länge L4	Preis pro Stück (CHF)				
							ab 1	ab 10	ab 25	ab 50	ab 100

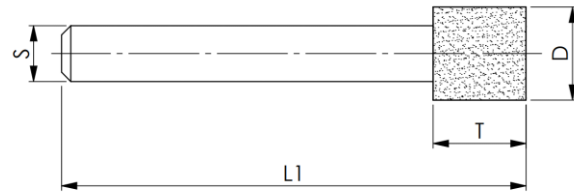
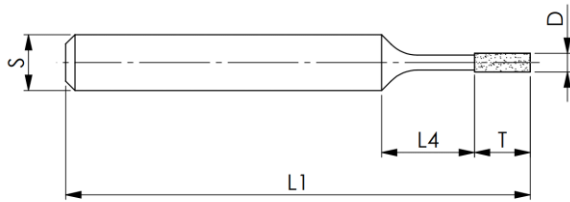

IF5000502D91	D91	Ø 0.5	2	Ø 3.0	40	6	17.80	16.05	15.15	14.70	14.25
IF5000602D91	D91	Ø 0.6	2	Ø 3.0	40	7	17.80	16.05	15.15	14.70	14.25
IF5000604D91	D91	Ø 0.6	4	Ø 3.0	40	5	17.80	16.05	15.15	14.70	14.25
IF5000702D91	D91	Ø 0.7	2	Ø 3.0	40	7	17.80	16.05	15.15	14.70	14.25
IF5000702D126	D126	Ø 0.7	2	Ø 3.0	40	7	17.80	16.05	15.15	14.70	14.25
IF5000702D151	D151	Ø 0.7	2	Ø 3.0	40	7	17.80	16.05	15.15	14.70	14.25
IF5000704D91	D91	Ø 0.7	4	Ø 3.0	40	5	17.80	16.05	15.15	14.70	14.25
IF5000704D126	D126	Ø 0.7	4	Ø 3.0	40	5	17.80	16.05	15.15	14.70	14.25
IF5000704D151	D151	Ø 0.7	4	Ø 3.0	40	5	17.80	16.05	15.15	14.70	14.25
IF5000802D91	D91	Ø 0.8	2	Ø 3.0	40	7	17.80	16.05	15.15	14.70	14.25
IF5000802D126	D126	Ø 0.8	2	Ø 3.0	40	7	17.80	16.05	15.15	14.70	14.25
IF5000802D151	D151	Ø 0.8	2	Ø 3.0	40	7	17.80	16.05	15.15	14.70	14.25
IF5000804D91	D91	Ø 0.8	4	Ø 3.0	40	5	17.80	16.05	15.15	14.70	14.25
IF5000804D126	D126	Ø 0.8	4	Ø 3.0	40	5	17.80	16.05	15.15	14.70	14.25
IF5000804D151	D151	Ø 0.8	4	Ø 3.0	40	5	17.80	16.05	15.15	14.70	14.25
IF5000904D91	D91	Ø 0.9	4	Ø 3.0	40	6	14.75	13.30	12.55	12.20	11.80
IF5000904D126	D126	Ø 0.9	4	Ø 3.0	40	6	15.30	13.80	13.05	12.65	12.25
IF5000904D151	D151	Ø 0.9	4	Ø 3.0	40	6	15.65	14.10	13.35	12.95	12.55
IF5001004D91	D91	Ø 1.0	4	Ø 3.0	40	6	13.30	12.00	11.35	11.00	10.65
IF5001004D126	D126	Ø 1.0	4	Ø 3.0	40	6	13.70	12.35	11.65	11.35	11.00
IF5001004D151	D151	Ø 1.0	4	Ø 3.0	40	6	13.85	12.50	11.80	11.45	11.10
IF5001204D91	D91	Ø 1.2	4	Ø 3.0	40	8	13.30	12.00	11.35	11.00	10.65
IF5001204D126	D126	Ø 1.2	4	Ø 3.0	40	8	13.70	12.35	11.65	11.35	11.00
IF5001204D151	D151	Ø 1.2	4	Ø 3.0	40	8	13.85	12.50	11.80	11.45	11.10
IF5001504D91	D91	Ø 1.5	4	Ø 3.0	40	10	13.30	12.00	11.35	11.00	10.65
IF5001504D126	D126	Ø 1.5	4	Ø 3.0	40	10	13.70	12.35	11.65	11.35	11.00
IF5001504D151	D151	Ø 1.5	4	Ø 3.0	40	10	14.05	12.65	11.95	11.60	11.25
IF5001704D91	D91	Ø 1.7	4	Ø 3.0	40	10	13.50	12.15	11.50	11.15	10.80
IF5001704D126	D126	Ø 1.7	4	Ø 3.0	40	10	13.85	12.50	11.80	11.45	11.10
IF5001704D151	D151	Ø 1.7	4	Ø 3.0	40	10	14.05	12.65	11.95	11.60	11.25
IF5002004D91	D91	Ø 2.0	4	Ø 3.0	40	12	13.50	12.15	11.50	11.15	10.80
IF5002004D126	D126	Ø 2.0	4	Ø 3.0	40	12	13.85	12.50	11.80	11.45	11.10
IF5002004D151	D151	Ø 2.0	4	Ø 3.0	40	12	14.05	12.65	11.95	11.60	11.25
IF5002504D91	D91	Ø 2.5	4	Ø 3.0	40	12	13.50	12.15	11.50	11.15	10.80
IF5002504D126	D126	Ø 2.5	4	Ø 3.0	40	12	13.85	12.50	11.80	11.45	11.10

Diamant-Schleifstifte Typ 50 mit Stahl-Schaft

Abmessungen in mm
PL201.02

WMC Produktcode	Korn	Kopf-Ø D	Länge T	Schaft-Ø S	Länge L1	Länge L4	Preis pro Stück (CHF)				
							ab 1	ab 10	ab 25	ab 50	ab 100
IF5002504D151	D151	Ø 2.5	4	Ø 3.0	40	12	14.20	12.80	12.10	11.75	11.40
IF5003005D91	D91	Ø 3.0	5	Ø 3.0	40	15	13.70	12.35	11.65	11.35	11.00
IF5003005D126	D126	Ø 3.0	5	Ø 3.0	40	15	14.05	12.65	11.95	11.60	11.25
IF5003005D151	D151	Ø 3.0	5	Ø 3.0	40	15	14.40	13.00	12.25	11.90	11.55
IF5003505D91	D91	Ø 3.5	5	Ø 3.0	50		16.20	14.60	13.80	13.40	13.00
IF5003505D126	D126	Ø 3.5	5	Ø 3.0	50		16.55	14.90	14.10	13.70	13.25
IF5003505D151	D151	Ø 3.5	5	Ø 3.0	50		17.10	15.40	14.55	14.15	13.70
IF5004005D91	D91	Ø 4.0	5	Ø 3.0	50		17.10	15.40	14.55	14.15	13.70
IF5004005D126	D126	Ø 4.0	5	Ø 3.0	50		17.80	16.05	15.15	14.70	14.25
IF5004005D151	D151	Ø 4.0	5	Ø 3.0	50		18.55	16.70	15.80	15.35	14.85
IF5004505D91	D91	Ø 4.5	5	Ø 3.0	50		18.00	16.20	15.30	14.85	14.40
IF5004505D126	D126	Ø 4.5	5	Ø 3.0	50		18.90	17.05	16.10	15.60	15.15
IF5004505D151	D151	Ø 4.5	5	Ø 3.0	50		19.80	17.85	16.85	16.35	15.85
IF5005007D91	D91	Ø 5.0	7	Ø 3.0	50		18.90	17.05	16.10	15.60	15.15
IF5005007D126	D126	Ø 5.0	7	Ø 3.0	50		19.80	17.85	16.85	16.35	15.85
IF5005007D151	D151	Ø 5.0	7	Ø 3.0	50		20.33	18.30	17.30	16.80	16.30
IF5006007D91	D91	Ø 6.0	7	Ø 6.0	60	13	20.15	18.15	17.15	16.65	16.15
IF5006007D126	D126	Ø 6.0	7	Ø 6.0	60	13	21.05	18.95	17.90	17.40	16.85
IF5006007D151	D151	Ø 6.0	7	Ø 6.0	60	13	21.80	19.65	18.55	18.00	17.45
IF5006107D91	D91	Ø 6.0	7	Ø 6.0	80	13	20.50	18.45	17.45	16.95	16.40
IF5006107D126	D126	Ø 6.0	7	Ø 6.0	80	13	21.60	19.45	18.40	17.85	17.30
IF5006107D151	D151	Ø 6.0	7	Ø 6.0	80	13	22.70	20.45	19.30	18.75	18.20
IF5007008D91	D91	Ø 7.0	8	Ø 6.0	60		24.30	21.90	20.70	20.05	19.45
IF5007008D126	D126	Ø 7.0	8	Ø 6.0	60		25.90	23.35	22.05	21.40	20.75
IF5007008D151	D151	Ø 7.0	8	Ø 6.0	60		27.20	24.50	23.15	22.45	21.80
IF5007108D91	D91	Ø 7.0	8	Ø 6.0	80		25.00	22.50	21.25	20.65	20.00
IF5007108D126	D126	Ø 7.0	8	Ø 6.0	80		26.45	23.85	22.50	21.85	21.20
IF5007108D151	D151	Ø 7.0	8	Ø 6.0	80		27.90	25.15	23.75	23.05	22.35
IF5008010D91	D91	Ø 8.0	10	Ø 6.0	60		25.55	23.00	21.75	21.10	20.45
IF5008010D126	D126	Ø 8.0	10	Ø 6.0	60		27.70	24.95	23.55	22.90	22.20
IF5008010D151	D151	Ø 8.0	10	Ø 6.0	60		28.80	25.95	24.50	23.80	23.05
IF5008110D91	D91	Ø 8.0	10	Ø 6.0	80		26.30	23.70	22.40	21.70	21.05
IF5008110D126	D126	Ø 8.0	10	Ø 6.0	80		28.10	25.30	23.90	23.20	22.50
IF5008110D151	D151	Ø 8.0	10	Ø 6.0	80		29.15	26.25	24.80	24.05	23.35
IF5010010D91	D91	Ø 10.0	10	Ø 6.0	60		27.55	24.80	23.45	22.75	22.05
IF5010010D126	D126	Ø 10.0	10	Ø 6.0	60		29.00	26.10	24.65	23.95	23.20
IF5010010D151	D151	Ø 10.0	10	Ø 6.0	60		30.60	27.55	26.05	25.25	24.50
IF5010110D91	D91	Ø 10.0	10	Ø 6.0	80		27.90	25.15	23.75	23.05	22.35
IF5010110D126	D126	Ø 10.0	10	Ø 6.0	80		29.50	26.55	25.10	24.35	23.60
IF5010110D151	D151	Ø 10.0	10	Ø 6.0	80		30.95	27.90	26.35	25.55	24.80
IF5012010D91	D91	Ø 12.0	10	Ø 6.0	60		29.00	26.10	24.65	23.95	23.20
IF5012010D126	D126	Ø 12.0	10	Ø 6.0	60		30.80	27.75	26.20	25.45	24.65

Diamant-Schleifstifte Typ 50 mit Stahl-Schaft

Abmessungen in mm
PL201.02

WMC Produktcode	Korn	Kopf-Ø D	Länge T	Schaft-Ø S	Länge L1	Länge L4	Preis pro Stück (CHF)				
							ab 1	ab 10	ab 25	ab 50	ab 100
IF5012010D151	D151	Ø 12.0	10	Ø 6.0	60		32.95	29.70	28.05	27.20	26.40
IF5012110D91	D91	Ø 12.0	10	Ø 6.0	80		29.90	26.95	25.45	24.70	23.95
IF5012110D126	D126	Ø 12.0	10	Ø 6.0	80		32.20	29.00	27.40	26.60	25.80
IF5012110D151	D151	Ø 12.0	10	Ø 6.0	80		34.20	30.80	29.10	28.25	27.40
IF5015010D91	D91	Ø 15.0	10	Ø 6.0	60		35.10	31.60	29.85	29.00	28.10
IF5015010D126	D126	Ø 15.0	10	Ø 6.0	60		37.25	33.55	31.70	30.75	29.80
IF5015010D151	D151	Ø 15.0	10	Ø 6.0	60		39.40	35.50	33.50	32.55	31.55
IF5015110D91	D91	Ø 15.0	10	Ø 6.0	80		35.80	32.25	30.45	29.55	28.65
IF5015110D126	D126	Ø 15.0	10	Ø 6.0	80		38.50	34.65	32.75	31.80	30.80
IF5015110D151	D151	Ø 15.0	10	Ø 6.0	80		40.70	36.65	34.60	33.60	32.60

Lieferfrist: ab Werklager 1 - 2 Arbeitswochen, Zwischenverkauf vorbehalten

CBN-Schleifstifte Typ 51 mit Stahl-Schaft

Abmessungen in mm
PL201.03

WMC Produktcode	Korn	Kopf-Ø D	Länge T	Schaft-Ø S	Länge L1	Länge L4	Preis pro Stück (CHF)				
							ab 1	ab 10	ab 25	ab 50	ab 100
IF5103005B91	B91	Ø 3.0	5	Ø 3.0	70	16	20.50	18.45	17.45	16.95	16.40
IF5103005B126	B126	Ø 3.0	5	Ø 3.0	70	16	21.40	19.30	18.20	17.70	17.15
IF5103005B151	B151	Ø 3.0	5	Ø 3.0	70	16	22.15	19.95	18.85	18.30	17.75
IF5103005B181	B181	Ø 3.0	5	Ø 3.0	70	16	22.15	19.95	18.85	18.30	17.75
IF5103005B252	B252	Ø 3.0	5	Ø 3.0	70	16	27.20	24.50	23.15	22.45	21.80
IF5103505B91	B91	Ø 3.5	5	Ø 3.0	75		25.40	22.90	21.60	21.00	20.35
IF5103505B126	B126	Ø 3.5	5	Ø 3.0	75		26.45	23.85	22.50	21.85	21.20
IF5103505B151	B151	Ø 3.5	5	Ø 3.0	75		27.20	24.50	23.15	22.45	21.80
IF5103505B181	B181	Ø 3.5	5	Ø 3.0	75		27.20	24.50	23.15	22.45	21.80
IF5103505B252	B252	Ø 3.5	5	Ø 3.0	75		32.40	29.20	27.55	26.75	25.95
IF5104005B91	B91	Ø 4.0	5	Ø 4.0	75		26.45	23.85	22.50	21.85	21.20
IF5104005B126	B126	Ø 4.0	5	Ø 4.0	75		27.55	24.80	23.45	22.75	22.05
IF5104005B151	B151	Ø 4.0	5	Ø 4.0	75		28.45	25.65	24.20	23.50	22.80
IF5104005B181	B181	Ø 4.0	5	Ø 4.0	75		28.45	25.65	24.20	23.50	22.80
IF5104005B252	B252	Ø 4.0	5	Ø 4.0	75		33.65	30.30	28.65	27.80	26.95
IF5104506B91	B91	Ø 4.5	6	Ø 4.0	75		27.55	24.80	23.45	22.75	22.05
IF5104506B126	B126	Ø 4.5	6	Ø 4.0	75		29.00	26.10	24.65	23.95	23.20
IF5104506B151	B151	Ø 4.5	6	Ø 4.0	75		29.90	26.95	25.45	24.70	23.95
IF5104506B181	B181	Ø 4.5	6	Ø 4.0	75		29.90	26.95	25.45	24.70	23.95
IF5104506B252	B252	Ø 4.5	6	Ø 4.0	75		35.65	32.10	30.35	29.45	28.55
IF5105007B91	B91	Ø 5.0	7	Ø 4.0	75		28.60	25.75	24.35	23.60	22.90
IF5105007B126	B126	Ø 5.0	7	Ø 4.0	75		29.70	26.75	25.25	24.55	23.80
IF5105007B151	B151	Ø 5.0	7	Ø 4.0	75		30.80	27.75	26.20	25.45	24.65
IF5105007B181	B181	Ø 5.0	7	Ø 4.0	75		30.80	27.75	26.20	25.45	24.65
IF5105007B252	B252	Ø 5.0	7	Ø 4.0	75		36.70	33.05	31.20	30.30	29.40
IF5105507B91	B91	Ø 5.5	7	Ø 5.0	75		29.35	26.45	24.95	24.25	23.50
IF5105507B126	B126	Ø 5.5	7	Ø 5.0	75		30.60	27.55	26.05	25.25	24.50
IF5105507B151	B151	Ø 5.5	7	Ø 5.0	75		31.70	28.55	26.95	26.20	25.40
IF5105507B181	B181	Ø 5.5	7	Ø 5.0	75		31.70	28.55	26.95	26.20	25.40
IF5105507B252	B252	Ø 5.5	7	Ø 5.0	75		37.80	34.05	32.15	31.20	30.25
IF5106008B91	B91	Ø 6.0	8	Ø 6.0	80		29.70	26.75	25.25	24.55	23.80
IF5106008B126	B126	Ø 6.0	8	Ø 6.0	80		30.95	27.90	26.35	25.55	24.80
IF5106008B151	B151	Ø 6.0	8	Ø 6.0	80		32.40	29.20	27.55	26.75	25.95
IF5106008B181	B181	Ø 6.0	8	Ø 6.0	80		32.40	29.20	27.55	26.75	25.95
IF5106008B252	B252	Ø 6.0	8	Ø 6.0	80		38.90	35.05	33.10	32.10	31.15

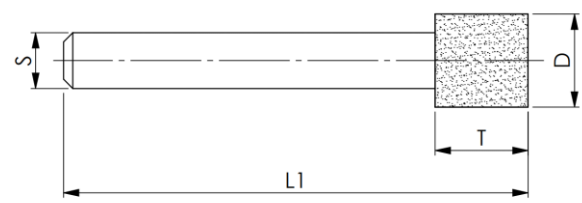
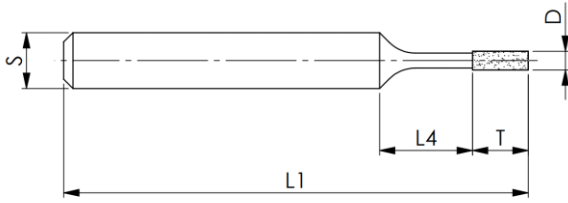

CBN-Schleifstifte Typ 51 mit Stahl-Schaft

Abmessungen in mm
PL201.03

WMC Produktcode	Korn	Kopf-Ø D	Länge T	Schaft-Ø S	Länge L1	Länge L4	Preis pro Stück (CHF)				
							ab 1	ab 10	ab 25	ab 50	ab 100
IF5106508B91	B91	Ø 6.5	8	Ø 6.0	80	29.90	26.95	25.45	24.70	23.95	
IF5106508B126	B126	Ø 6.5	8	Ø 6.0	80	31.50	28.35	26.80	26.00	25.20	
IF5106508B151	B151	Ø 6.5	8	Ø 6.0	80	32.95	29.70	28.05	27.20	26.40	
IF5106508B181	B181	Ø 6.5	8	Ø 6.0	80	32.95	29.70	28.05	27.20	26.40	
IF5106508B252	B252	Ø 6.5	8	Ø 6.0	80	39.40	35.50	33.50	32.55	31.55	
IF5107508B91	B91	Ø 7.5	8	Ø 6.0	80	30.25	27.25	25.75	25.00	24.20	
IF5107508B126	B126	Ø 7.5	8	Ø 6.0	80	32.20	29.00	27.40	26.60	25.80	
IF5107508B151	B151	Ø 7.5	8	Ø 6.0	80	33.85	30.50	28.80	27.95	27.10	
IF5107508B181	B181	Ø 7.5	8	Ø 6.0	80	33.85	30.50	28.80	27.95	27.10	
IF5107508B252	B252	Ø 7.5	8	Ø 6.0	80	40.85	36.80	34.75	33.75	32.70	
IF5108008B91	B91	Ø 8.0	8	Ø 6.0	80	30.95	27.90	26.35	25.55	24.80	
IF5108008B126	B126	Ø 8.0	8	Ø 6.0	80	33.30	30.00	28.35	27.50	26.65	
IF5108008B151	B151	Ø 8.0	8	Ø 6.0	80	34.90	31.45	29.70	28.80	27.95	
IF5108008B181	B181	Ø 8.0	8	Ø 6.0	80	34.90	31.45	29.70	28.80	27.95	
IF5108008B252	B252	Ø 8.0	8	Ø 6.0	80	42.65	38.40	36.30	35.20	34.15	
IF5108508B91	B91	Ø 8.5	8	Ø 6.0	80	31.30	28.20	26.65	25.85	25.05	
IF5108508B126	B126	Ø 8.5	8	Ø 6.0	80	33.50	30.15	28.50	27.65	26.80	
IF5108508B151	B151	Ø 8.5	8	Ø 6.0	80	35.45	31.95	30.15	29.25	28.40	
IF5108508B181	B181	Ø 8.5	8	Ø 6.0	80	35.45	31.95	30.15	29.25	28.40	
IF5108508B252	B252	Ø 8.5	8	Ø 6.0	80	43.20	38.90	36.75	35.65	34.60	
IF5109010B91	B91	Ø 9.0	10	Ø 8.0	100	33.30	30.00	28.35	27.50	26.65	
IF5109010B126	B126	Ø 9.0	10	Ø 8.0	100	35.65	32.10	30.35	29.45	28.55	
IF5109010B151	B151	Ø 9.0	10	Ø 8.0	100	37.80	34.05	32.15	31.20	30.25	
IF5109010B181	B181	Ø 9.0	10	Ø 8.0	100	37.80	34.05	32.15	31.20	30.25	
IF5109010B252	B252	Ø 9.0	10	Ø 8.0	100	46.80	42.15	39.80	38.65	37.45	
IF5109510B91	B91	Ø 9.5	10	Ø 8.0	100	34.90	31.45	29.70	28.80	27.95	
IF5109510B126	B126	Ø 9.5	10	Ø 8.0	100	37.45	33.75	31.85	30.90	30.00	
IF5109510B151	B151	Ø 9.5	10	Ø 8.0	100	39.95	36.00	34.00	33.00	32.00	
IF5109510B181	B181	Ø 9.5	10	Ø 8.0	100	39.95	36.00	34.00	33.00	32.00	
IF5109510B252	B252	Ø 9.5	10	Ø 8.0	100	49.15	44.25	41.80	40.55	39.35	
IF5110010B91	B91	Ø 10.0	10	Ø 8.0	100	37.60	33.85	32.00	31.05	30.10	
IF5110010B126	B126	Ø 10.0	10	Ø 8.0	100	40.30	36.30	34.30	33.25	32.25	
IF5110010B151	B151	Ø 10.0	10	Ø 8.0	100	43.00	38.70	36.55	35.50	34.40	
IF5110010B181	B181	Ø 10.0	10	Ø 8.0	100	43.00	38.70	36.55	35.50	34.40	
IF5110010B252	B252	Ø 10.0	10	Ø 8.0	100	52.55	47.30	44.70	43.40	42.05	
IF5111010B91	B91	Ø 11.0	10	Ø 10.0	110	38.70	34.85	32.90	31.95	31.00	
IF5111010B126	B126	Ø 11.0	10	Ø 10.0	110	41.40	37.30	35.20	34.20	33.15	
IF5111010B151	B151	Ø 11.0	10	Ø 10.0	110	43.90	39.55	37.35	36.25	35.15	
IF5111010B181	B181	Ø 11.0	10	Ø 10.0	110	43.90	39.55	37.35	36.25	35.15	
IF5111010B252	B252	Ø 11.0	10	Ø 10.0	110	53.80	48.45	45.75	44.40	43.05	
IF5112010B91	B91	Ø 12.0	10	Ø 10.0	110	41.05	36.95	34.90	33.90	32.85	
IF5112010B126	B126	Ø 12.0	10	Ø 10.0	110	43.90	39.55	37.35	36.25	35.15	

CBN-Schleifstifte Typ 51 mit Stahl-Schaft

Abmessungen in mm
PL201.03

WMC Produktcode	Korn	Kopf-Ø D	Länge T	Schaft-Ø S	Länge L1	Länge L4	Preis pro Stück (CHF)				
							ab 1	ab 10	ab 25	ab 50	ab 100
IF5112010B151	B151	Ø 12.0	10	Ø 10.0	110		47.00	42.30	39.95	38.80	37.60
IF5112010B181	B181	Ø 12.0	10	Ø 10.0	110		47.00	42.30	39.95	38.80	37.60
IF5112010B252	B252	Ø 12.0	10	Ø 10.0	110		57.40	51.70	48.80	47.40	45.95
IF5113010B91	B91	Ø 13.0	10	Ø 10.0	110		41.95	37.80	35.70	34.65	33.60
IF5113010B126	B126	Ø 13.0	10	Ø 10.0	110		45.20	40.70	38.45	37.30	36.20
IF5113010B151	B151	Ø 13.0	10	Ø 10.0	110		48.25	43.45	41.05	39.85	38.60
IF5113010B181	B181	Ø 13.0	10	Ø 10.0	110		48.25	43.45	41.05	39.85	38.60
IF5113010B252	B252	Ø 13.0	10	Ø 10.0	110		59.05	53.15	50.20	48.75	47.25
IF5114010B91	B91	Ø 14.0	10	Ø 10.0	110		42.65	38.40	36.30	35.20	34.15
IF5114010B126	B126	Ø 14.0	10	Ø 10.0	110		45.70	41.15	38.85	37.75	36.60
IF5114010B151	B151	Ø 14.0	10	Ø 10.0	110		49.15	44.25	41.80	40.55	39.35
IF5114010B181	B181	Ø 14.0	10	Ø 10.0	110		49.15	44.25	41.80	40.55	39.35
IF5114010B252	B252	Ø 14.0	10	Ø 10.0	110		61.00	54.90	51.85	50.35	48.80
IF5115010B91	B91	Ø 15.0	10	Ø 10.0	110		43.00	38.70	36.55	35.50	34.40
IF5115010B126	B126	Ø 15.0	10	Ø 10.0	110		46.80	42.15	39.80	38.65	37.45
IF5115010B151	B151	Ø 15.0	10	Ø 10.0	110		50.20	45.20	42.70	41.45	40.20
IF5115010B181	B181	Ø 15.0	10	Ø 10.0	110		50.20	45.20	42.70	41.45	40.20
IF5115010B252	B252	Ø 15.0	10	Ø 10.0	110		62.45	56.25	53.10	51.55	50.00

Lieferfrist: ab Werklager 1 - 2 Arbeitswochen, Zwischenverkauf vorbehalten

Diamant-Schleifstifte Typ 51 mit Stahl-Schaft

Abmessungen in mm
PL201.04

WMC Produktcode	Korn	Kopf-Ø D	Länge T	Schaft-Ø S	Länge L1	Länge L4	Preis pro Stück (CHF)				
							ab 1	ab 10	ab 25	ab 50	ab 100
IF5103005D91	D91	Ø 3.0	5	Ø 3.0	70	16	20.35	18.35	17.30	16.80	16.30
IF5103005D126	D126	Ø 3.0	5	Ø 3.0	70	16	21.25	19.15	18.10	17.55	17.00
IF5103005D151	D151	Ø 3.0	5	Ø 3.0	70	16	21.80	19.65	18.55	18.00	17.45
IF5103005D181	D181	Ø 3.0	5	Ø 3.0	70	16	21.80	19.65	18.55	18.00	17.45
IF5103505D91	D91	Ø 3.5	5	Ø 3.0	75		25.20	22.70	21.45	20.80	20.20
IF5103505D126	D126	Ø 3.5	5	Ø 3.0	75		26.30	23.70	22.40	21.70	21.05
IF5103505D151	D151	Ø 3.5	5	Ø 3.0	75		26.80	24.15	22.80	22.15	21.45
IF5103505D181	D181	Ø 3.5	5	Ø 3.0	75		26.80	24.15	22.80	22.15	21.45
IF5104005D91	D91	Ø 4.0	5	Ø 3.5	75		26.30	23.70	22.40	21.70	21.05
IF5104005D126	D126	Ø 4.0	5	Ø 3.5	75		27.00	24.30	22.95	22.30	21.60
IF5104005D151	D151	Ø 4.0	5	Ø 3.5	75		28.10	25.30	23.90	23.20	22.50
IF5104005D181	D181	Ø 4.0	5	Ø 3.5	75		28.10	25.30	23.90	23.20	22.50
IF5104506D91	D91	Ø 4.5	6	Ø 4.0	75		26.45	23.85	22.50	21.85	21.20
IF5104506D126	D126	Ø 4.5	6	Ø 4.0	75		28.25	25.45	24.05	23.35	22.60
IF5104506D151	D151	Ø 4.5	6	Ø 4.0	75		29.00	26.10	24.65	23.95	23.20
IF5104506D181	D181	Ø 4.5	6	Ø 4.0	75		29.00	26.10	24.65	23.95	23.20
IF5105007D91	D91	Ø 5.0	7	Ø 4.5	75		28.25	25.45	24.05	23.35	22.60
IF5105007D126	D126	Ø 5.0	7	Ø 4.5	75		29.15	26.25	24.80	24.05	23.35
IF5105007D151	D151	Ø 5.0	7	Ø 4.5	75		29.90	26.95	25.45	24.70	23.95
IF5105007D181	D181	Ø 5.0	7	Ø 4.5	75		29.90	26.95	25.45	24.70	23.95
IF5105507D91	D91	Ø 5.5	7	Ø 5.0	75		28.80	25.95	24.50	23.80	23.05
IF5105507D126	D126	Ø 5.5	7	Ø 5.0	75		29.90	26.95	25.45	24.70	23.95
IF5105507D151	D151	Ø 5.5	7	Ø 5.0	75		30.80	27.75	26.20	25.45	24.65
IF5105507D181	D181	Ø 5.5	7	Ø 5.0	75		30.80	27.75	26.20	25.45	24.65
IF5106008D91	D91	Ø 6.0	8	Ø 5.5	80		29.00	26.10	24.65	23.95	23.20
IF5106008D126	D126	Ø 6.0	8	Ø 5.5	80		30.25	27.25	25.75	25.00	24.20
IF5106008D151	D151	Ø 6.0	8	Ø 5.5	80		31.30	28.20	26.65	25.85	25.05
IF5106008D181	D181	Ø 6.0	8	Ø 5.5	80		31.30	28.20	26.65	25.85	25.05
IF5106508D91	D91	Ø 6.5	8	Ø 6.0	80		28.10	25.30	23.90	23.20	22.50
IF5106508D126	D126	Ø 6.5	8	Ø 6.0	80		30.40	27.40	25.85	25.10	24.35
IF5106508D151	D151	Ø 6.5	8	Ø 6.0	80		31.50	28.35	26.80	26.00	25.20
IF5106508D181	D181	Ø 6.5	8	Ø 6.0	80		31.50	28.35	26.80	26.00	25.20
IF5107508D91	D91	Ø 7.5	8	Ø 6.0	80		29.50	26.55	25.10	24.35	23.60
IF5107508D126	D126	Ø 7.5	8	Ø 6.0	80		30.80	27.75	26.20	25.45	24.65
IF5107508D151	D151	Ø 7.5	8	Ø 6.0	80		32.20	29.00	27.40	26.60	25.80
IF5107508D181	D181	Ø 7.5	8	Ø 6.0	80		32.20	29.00	27.40	26.60	25.80

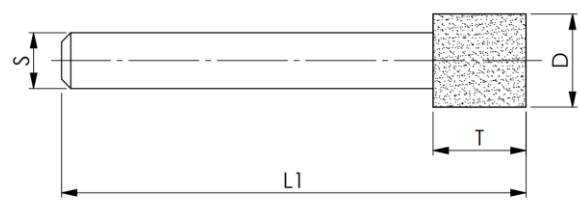
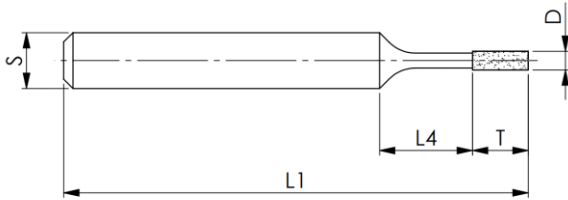

Diamant-Schleifstifte Typ 51 mit Stahl-Schaft

Abmessungen in mm
PL201.04

WMC Produktcode	Korn	Kopf-Ø D	Länge T	Schaft-Ø S	Länge L1	Länge L4	Preis pro Stück (CHF)				
							ab 1	ab 10	ab 25	ab 50	ab 100
IF5108008D91	D91	Ø 8.0	8	Ø 6.0	80		30.05	27.05	25.55	24.80	24.05
IF5108008D126	D126	Ø 8.0	8	Ø 6.0	80		31.50	28.35	26.80	26.00	25.20
IF5108008D151	D151	Ø 8.0	8	Ø 6.0	80		33.30	30.00	28.35	27.50	26.65
IF5108008D181	D181	Ø 8.0	8	Ø 6.0	80		33.30	30.00	28.35	27.50	26.65
IF5108508D91	D91	Ø 8.5	8	Ø 6.0	80		30.05	27.05	25.55	24.80	24.05
IF5108508D126	D126	Ø 8.5	8	Ø 6.0	80		31.85	28.70	27.10	26.30	25.50
IF5108508D151	D151	Ø 8.5	8	Ø 6.0	80		33.50	30.15	28.50	27.65	26.80
IF5108508D181	D181	Ø 8.5	8	Ø 6.0	80		33.50	30.15	28.50	27.65	26.80
IF5109010D91	D91	Ø 9.0	10	Ø 8.0	100		31.50	28.35	26.80	26.00	25.20
IF5109010D126	D126	Ø 9.0	10	Ø 8.0	100		33.85	30.50	28.80	27.95	27.10
IF5109010D151	D151	Ø 9.0	10	Ø 8.0	100		35.45	31.95	30.15	29.25	28.40
IF5109010D181	D181	Ø 9.0	10	Ø 8.0	100		35.45	31.95	30.15	29.25	28.40
IF5109510D91	D91	Ø 9.5	10	Ø 8.0	100		33.65	30.30	28.65	27.80	26.95
IF5109510D126	D126	Ø 9.5	10	Ø 8.0	100		35.65	32.10	30.35	29.45	28.55
IF5109510D151	D151	Ø 9.5	10	Ø 8.0	100		37.45	33.75	31.85	30.90	30.00
IF5109510D181	D181	Ø 9.5	10	Ø 8.0	100		37.45	33.75	31.85	30.90	30.00
IF5110010D91	D91	Ø 10.0	10	Ø 8.0	100		36.00	32.40	30.60	29.70	28.80
IF5110010D126	D126	Ø 10.0	10	Ø 8.0	100		38.35	34.55	32.60	31.65	30.70
IF5110010D151	D151	Ø 10.0	10	Ø 8.0	100		40.15	36.15	34.15	33.15	32.15
IF5110010D181	D181	Ø 10.0	10	Ø 8.0	100		40.15	36.15	34.15	33.15	32.15
IF5111010D91	D91	Ø 11.0	10	Ø 10.0	110		37.10	33.40	31.55	30.65	29.70
IF5111010D126	D126	Ø 11.0	10	Ø 10.0	110		39.05	35.15	33.20	32.25	31.25
IF5111010D151	D151	Ø 11.0	10	Ø 10.0	110		41.20	37.10	35.05	34.00	33.00
IF5111010D181	D181	Ø 11.0	10	Ø 10.0	110		41.20	37.10	35.05	34.00	33.00
IF5112010D91	D91	Ø 12.0	10	Ø 10.0	110		39.05	35.15	33.20	32.25	31.25
IF5112010D126	D126	Ø 12.0	10	Ø 10.0	110		41.60	37.45	35.40	34.35	33.30
IF5112010D151	D151	Ø 12.0	10	Ø 10.0	110		43.75	39.40	37.20	36.10	35.00
IF5112010D181	D181	Ø 12.0	10	Ø 10.0	110		43.75	39.40	37.20	36.10	35.00
IF5113010D91	D91	Ø 13.0	10	Ø 10.0	110		39.95	36.00	34.00	33.00	32.00
IF5113010D126	D126	Ø 13.0	10	Ø 10.0	110		42.65	38.40	36.30	35.20	34.15
IF5113010D151	D151	Ø 13.0	10	Ø 10.0	110		45.00	40.50	38.25	37.15	36.00
IF5113010D181	D181	Ø 13.0	10	Ø 10.0	110		45.00	40.50	38.25	37.15	36.00
IF5114010D91	D91	Ø 14.0	10	Ø 10.0	110		40.30	36.30	34.30	33.25	32.25
IF5114010D126	D126	Ø 14.0	10	Ø 10.0	110		43.20	38.90	36.75	35.65	34.60
IF5114010D151	D151	Ø 14.0	10	Ø 10.0	110		45.35	40.85	38.55	37.45	36.30
IF5114010D181	D181	Ø 14.0	10	Ø 10.0	110		45.35	40.85	38.55	37.45	36.30
IF5115010D91	D91	Ø 15.0	10	Ø 10.0	110		40.85	36.80	34.75	33.75	32.70
IF5115010D126	D126	Ø 15.0	10	Ø 10.0	110		43.75	39.40	37.20	36.10	35.00
IF5115010D151	D151	Ø 15.0	10	Ø 10.0	110		46.60	41.95	39.65	38.45	37.30
IF5115010D181	D181	Ø 15.0	10	Ø 10.0	110		46.60	41.95	39.65	38.45	37.30

Lieferfrist: ab Werklager 1 - 2 Arbeitswochen, Zwischenverkauf vorbehalten

CBN-Schleifstifte Typ 55 mit Hartmetall-Schaft

Abmessungen in mm
PL201.05

WMC Produktcode	Korn	Kopf-Ø D	Länge T	Schaft-Ø S	Länge L1	Länge L4	Preis pro Stück (CHF)				
							ab 1	ab 10	ab 25	ab 50	ab 100
IK5500404B64	B64	Ø 0.4	3	Ø 3.0	40	5	19.45	17.55	16.55	16.05	15.60
IK5500504B76	B76	Ø 0.5	3	Ø 3.0	40	6	19.45	17.55	16.55	16.05	15.60
IK5500604B91	B91	Ø 0.6	4	Ø 3.0	40	5	19.45	17.55	16.55	16.05	15.60
IK5500604B126	B126	Ø 0.6	4	Ø 3.0	40	5	19.45	17.55	16.55	16.05	15.60
IK5500704B91	B91	Ø 0.7	4	Ø 3.0	40	5	18.70	16.85	15.90	15.45	15.00
IK5500704B126	B126	Ø 0.7	4	Ø 3.0	40	5	18.70	16.85	15.90	15.45	15.00
IK5500704B151	B151	Ø 0.7	4	Ø 3.0	40	5	18.70	16.85	15.90	15.45	15.00
IK5500804B91	B91	Ø 0.8	4	Ø 3.0	40	5	18.70	16.85	15.90	15.45	15.00
IK5500804B126	B126	Ø 0.8	4	Ø 3.0	40	5	18.70	16.85	15.90	15.45	15.00
IK5500804B151	B151	Ø 0.8	4	Ø 3.0	40	5	18.70	16.85	15.90	15.45	15.00
IK5500904B91	B91	Ø 0.9	4	Ø 3.0	40	6	18.70	16.85	15.90	15.45	15.00
IK5500904B126	B126	Ø 0.9	4	Ø 3.0	40	6	18.70	16.85	15.90	15.45	15.00
IK5500904B151	B151	Ø 0.9	4	Ø 3.0	40	6	18.70	16.85	15.90	15.45	15.00
IK5501004B91	B91	Ø 1.0	4	Ø 3.0	40	16	17.80	16.05	15.15	14.70	14.25
IK5501004B126	B126	Ø 1.0	4	Ø 3.0	40	16	17.80	16.05	15.15	14.70	14.25
IK5501004B151	B151	Ø 1.0	4	Ø 3.0	40	16	17.80	16.05	15.15	14.70	14.25
IK5501204B91	B91	Ø 1.2	4	Ø 3.0	40	16	17.80	16.05	15.15	14.70	14.25
IK5501204B126	B126	Ø 1.2	4	Ø 3.0	40	16	17.80	16.05	15.15	14.70	14.25
IK5501204B151	B151	Ø 1.2	4	Ø 3.0	40	16	17.80	16.05	15.15	14.70	14.25
IK5501504B91	B91	Ø 1.5	4	Ø 3.0	40	16	17.80	16.05	15.15	14.70	14.25
IK5501504B126	B126	Ø 1.5	4	Ø 3.0	40	16	17.80	16.05	15.15	14.70	14.25
IK5501504B151	B151	Ø 1.5	4	Ø 3.0	40	16	17.80	16.05	15.15	14.70	14.25
IK5501704B91	B91	Ø 1.7	4	Ø 3.0	40	16	17.80	16.05	15.15	14.70	14.25
IK5501704B126	B126	Ø 1.7	4	Ø 3.0	40	16	17.80	16.05	15.15	14.70	14.25
IK5501704B151	B151	Ø 1.7	4	Ø 3.0	40	16	17.80	16.05	15.15	14.70	14.25
IK5502004B91	B91	Ø 2.0	4	Ø 3.0	40	16	17.80	16.05	15.15	14.70	14.25
IK5502004B126	B126	Ø 2.0	4	Ø 3.0	40	16	17.80	16.05	15.15	14.70	14.25
IK5502004B151	B151	Ø 2.0	4	Ø 3.0	40	16	17.80	16.05	15.15	14.70	14.25
IK5502204B91	B91	Ø 2.2	4	Ø 3.0	40	16	18.70	16.85	15.90	15.45	15.00
IK5502204B126	B126	Ø 2.2	4	Ø 3.0	40	16	18.70	16.85	15.90	15.45	15.00
IK5502204B151	B151	Ø 2.2	4	Ø 3.0	40	16	18.70	16.85	15.90	15.45	15.00
IK5502504B91	B91	Ø 2.5	4	Ø 3.0	40	16	18.70	16.85	15.90	15.45	15.00
IK5502504B126	B126	Ø 2.5	4	Ø 3.0	40	16	18.70	16.85	15.90	15.45	15.00
IK5502504B151	B151	Ø 2.5	4	Ø 3.0	40	16	18.70	16.85	15.90	15.45	15.00
IK5503005B91	B91	Ø 3.0	5	Ø 3.0	75	15	30.95	27.90	26.35	25.55	24.80

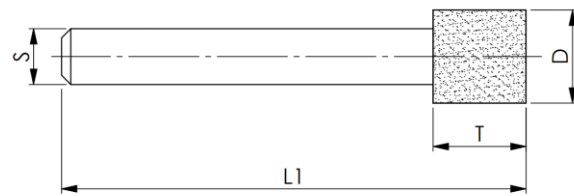
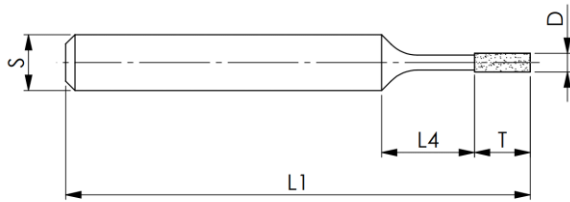

CBN-Schleifstifte Typ 55 mit Hartmetall-Schaft

Abmessungen in mm
PL201.05

WMC Produktcode	Korn	Kopf-Ø D	Länge T	Schaft-Ø S	Länge L1	Länge L4	Preis pro Stück (CHF)				
							ab 1	ab 10	ab 25	ab 50	ab 100
IK5503005B126	B126	Ø 3.0	5	Ø 3.0	75	15	30.95	27.90	26.35	25.55	24.80
IK5503005B151	B151	Ø 3.0	5	Ø 3.0	75	15	30.95	27.90	26.35	25.55	24.80
IK5503205B91	B91	Ø 3.2	5	Ø 3.0	75		30.25	27.25	25.75	25.00	24.20
IK5503305B126	B126	Ø 3.3	5	Ø 3.0	75		30.25	27.25	25.75	25.00	24.20
IK5503405B151	B151	Ø 3.4	5	Ø 3.0	75		30.25	27.25	25.75	25.00	24.20
IK5503505B91	B91	Ø 3.5	5	Ø 3.0	75		45.90	41.35	39.05	37.90	36.75
IK5503505B126	B126	Ø 3.5	5	Ø 3.0	75		45.90	41.35	39.05	37.90	36.75
IK5503505B151	B151	Ø 3.5	5	Ø 3.0	75		45.90	41.35	39.05	37.90	36.75
IK5504005B91	B91	Ø 4.0	5	Ø 3.0	75		49.70	44.75	42.25	41.05	39.80
IK5504005B126	B126	Ø 4.0	5	Ø 3.0	75		49.70	44.75	42.25	41.05	39.80
IK5504005B151	B151	Ø 4.0	5	Ø 3.0	75		49.70	44.75	42.25	41.05	39.80
IK5504205B91	B91	Ø 4.2	5	Ø 4.0	75		37.60	33.85	32.00	31.05	30.10
IK5504305B126	B126	Ø 4.3	5	Ø 4.0	75		37.60	33.85	32.00	31.05	30.10
IK5504405B151	B151	Ø 4.4	5	Ø 4.0	75		37.60	33.85	32.00	31.05	30.10
IK5504505B91	B91	Ø 4.5	5	Ø 3.0	75		53.45	48.15	45.45	44.10	42.80
IK5504505B126	B126	Ø 4.5	5	Ø 3.0	75		53.45	48.15	45.45	44.10	42.80
IK5504505B151	B151	Ø 4.5	5	Ø 3.0	75		53.45	48.15	45.45	44.10	42.80
IK5505005B91	B91	Ø 5.0	5	Ø 3.0	75		54.70	49.25	46.50	45.15	43.80
IK5505005B126	B126	Ø 5.0	5	Ø 3.0	75		54.70	49.25	46.50	45.15	43.80
IK5505005B151	B151	Ø 5.0	5	Ø 3.0	75		54.70	49.25	46.50	45.15	43.80
IK5506006B91	B91	Ø 6.0	6	Ø 6.0	100	36	57.95	52.20	49.30	47.85	46.40
IK5506006B126	B126	Ø 6.0	6	Ø 6.0	100	36	57.95	52.20	49.30	47.85	46.40
IK5506006B151	B151	Ø 6.0	6	Ø 6.0	100	36	57.95	52.20	49.30	47.85	46.40
IK5506206B91	B91	Ø 6.2	6	Ø 6.0	100		50.20	45.20	42.70	41.45	40.20
IK5506306B126	B126	Ø 6.3	6	Ø 6.0	100		50.20	45.20	42.70	41.45	40.20
IK5506406B151	B151	Ø 6.4	6	Ø 6.0	100		50.20	45.20	42.70	41.45	40.20
IK5507008B91	B91	Ø 7.0	8	Ø 6.0	100		80.65	72.60	68.60	66.55	64.55
IK5507008B126	B126	Ø 7.0	8	Ø 6.0	100		80.65	72.60	68.60	66.55	64.55
IK5507008B151	B151	Ø 7.0	8	Ø 6.0	100		80.65	72.60	68.60	66.55	64.55
IK5508008B91	B91	Ø 8.0	8	Ø 6.0	100		80.65	72.60	68.60	66.55	64.55
IK5508008B126	B126	Ø 8.0	8	Ø 6.0	100		80.65	72.60	68.60	66.55	64.55
IK5508008B151	B151	Ø 8.0	8	Ø 6.0	100		80.65	72.60	68.60	66.55	64.55
IK5508208B91	B91	Ø 8.2	8	Ø 8.0	100		77.60	69.85	66.00	64.05	62.10
IK5508308B126	B126	Ø 8.3	8	Ø 8.0	100		77.60	69.85	66.00	64.05	62.10
IK5508408B151	B151	Ø 8.4	8	Ø 8.0	100		77.60	69.85	66.00	64.05	62.10
IK5510010B91	B91	Ø 10.0	10	Ø 8.0	100		104.20	93.80	88.60	86.00	83.40
IK5510010B126	B126	Ø 10.0	10	Ø 8.0	100		104.20	93.80	88.60	86.00	83.40
IK5510010B151	B151	Ø 10.0	10	Ø 8.0	100		104.20	93.80	88.60	86.00	83.40
IK5510210B91	B91	Ø 10.2	10	Ø 10.0	110		99.90	89.95	84.95	82.45	79.95
IK5510310B126	B126	Ø 10.3	10	Ø 10.0	110		99.90	89.95	84.95	82.45	79.95
IK5510410B151	B151	Ø 10.4	10	Ø 10.0	110		99.90	89.95	84.95	82.45	79.95
IK5512010B91	B91	Ø 12.0	10	Ø 10.0	110		114.30	102.90	97.20	94.30	91.45

CBN-Schleifstifte Typ 55 mit Hartmetall-Schaft

Abmessungen in mm
PL201.05

WMC Produktcode	Korn	Kopf-Ø D	Länge T	Schaft-Ø S	Länge L1	Länge L4	Preis pro Stück (CHF)				
							ab 1	ab 10	ab 25	ab 50	ab 100
IK5512010B126	B126	Ø 12.0	10	Ø 10.0	110		114.30	102.90	97.20	94.30	91.45
IK5512010B151	B151	Ø 12.0	10	Ø 10.0	110		114.30	102.90	97.20	94.30	91.45
IK5513010B91	B91	Ø 13.0	10	Ø 10.0	110		120.40	108.40	102.35	99.35	96.35
IK5513010B126	B126	Ø 13.0	10	Ø 10.0	110		120.40	108.40	102.35	99.35	96.35
IK5513010B151	B151	Ø 13.0	10	Ø 10.0	110		120.40	108.40	102.35	99.35	96.35
IK5514010B91	B91	Ø 14.0	10	Ø 10.0	110		128.50	115.65	109.25	106.05	102.80
IK5514010B126	B126	Ø 14.0	10	Ø 10.0	110		128.50	115.65	109.25	106.05	102.80
IK5514010B151	B151	Ø 14.0	10	Ø 10.0	110		128.50	115.65	109.25	106.05	102.80
IK5515010B91	B91	Ø 15.0	10	Ø 10.0	110		132.85	119.60	112.95	109.65	106.30
IK5515010B126	B126	Ø 15.0	10	Ø 10.0	110		132.85	119.60	112.95	109.65	106.30
IK5515010B151	B151	Ø 15.0	10	Ø 10.0	110		132.85	119.60	112.95	109.65	106.30

Lieferfrist: ab Werklager 1 - 2 Arbeitswochen, Zwischenverkauf vorbehalten

Diamant-Schleifstifte Typ 55 mit Hartmetall-Schaft

Abmessungen in mm
PL201.06

WMC Produktcode	Korn	Kopf-Ø D	Länge T	Schaft-Ø S	Länge L1	Länge L4	Preis pro Stück (CHF)				
							ab 1	ab 10	ab 25	ab 50	ab 100
IK5500404D64	D64	Ø 0.4	3	Ø 3.0	40	5	19.45	17.55	16.55	16.05	15.60
IK5500504D76	D76	Ø 0.5	3	Ø 3.0	40	6	19.45	17.55	16.55	16.05	15.60
IK5500604D91	D91	Ø 0.6	4	Ø 3.0	40	5	19.45	17.55	16.55	16.05	15.60
IK5500604D126	D126	Ø 0.6	4	Ø 3.0	40	5	19.45	17.55	16.55	16.05	15.60
IK5500704D91	D91	Ø 0.7	4	Ø 3.0	40	5	18.70	16.85	15.90	15.45	15.00
IK5500704D126	D126	Ø 0.7	4	Ø 3.0	40	5	18.70	16.85	15.90	15.45	15.00
IK5500704D151	D151	Ø 0.7	4	Ø 3.0	40	5	18.70	16.85	15.90	15.45	15.00
IK5500804D91	D91	Ø 0.8	4	Ø 3.0	40	5	18.70	16.85	15.90	15.45	15.00
IK5500804D126	D126	Ø 0.8	4	Ø 3.0	40	5	18.70	16.85	15.90	15.45	15.00
IK5500804D151	D151	Ø 0.8	4	Ø 3.0	40	5	18.70	16.85	15.90	15.45	15.00
IK5500904D91	D91	Ø 0.9	4	Ø 3.0	40	6	18.70	16.85	15.90	15.45	15.00
IK5500904D126	D126	Ø 0.9	4	Ø 3.0	40	6	18.70	16.85	15.90	15.45	15.00
IK5500904D151	D151	Ø 0.9	4	Ø 3.0	40	6	18.70	16.85	15.90	15.45	15.00
IK5501004D91	D91	Ø 1.0	4	Ø 3.0	40	16	17.80	16.05	15.15	14.70	14.25
IK5501004D126	D126	Ø 1.0	4	Ø 3.0	40	16	17.80	16.05	15.15	14.70	14.25
IK5501004D151	D151	Ø 1.0	4	Ø 3.0	40	16	17.80	16.05	15.15	14.70	14.25
IK5501204D91	D91	Ø 1.2	4	Ø 3.0	40	16	17.80	16.05	15.15	14.70	14.25
IK5501204D126	D126	Ø 1.2	4	Ø 3.0	40	16	17.80	16.05	15.15	14.70	14.25
IK5501204D151	D151	Ø 1.2	4	Ø 3.0	40	16	17.80	16.05	15.15	14.70	14.25
IK5501504D91	D91	Ø 1.5	4	Ø 3.0	40	16	17.80	16.05	15.15	14.70	14.25
IK5501504D126	D126	Ø 1.5	4	Ø 3.0	40	16	17.80	16.05	15.15	14.70	14.25
IK5501504D151	D151	Ø 1.5	4	Ø 3.0	40	16	17.80	16.05	15.15	14.70	14.25
IK5501704D91	D91	Ø 1.7	4	Ø 3.0	40	16	17.80	16.05	15.15	14.70	14.25
IK5501704D126	D126	Ø 1.7	4	Ø 3.0	40	16	17.80	16.05	15.15	14.70	14.25
IK5501704D151	D151	Ø 1.7	4	Ø 3.0	40	16	17.80	16.05	15.15	14.70	14.25
IK5502004D91	D91	Ø 2.0	4	Ø 3.0	40	16	17.80	16.05	15.15	14.70	14.25
IK5502004D126	D126	Ø 2.0	4	Ø 3.0	40	16	17.80	16.05	15.15	14.70	14.25
IK5502004D151	D151	Ø 2.0	4	Ø 3.0	40	16	17.80	16.05	15.15	14.70	14.25
IK5502204D91	D91	Ø 2.2	4	Ø 3.0	40	16	18.70	16.85	15.90	15.45	15.00
IK5502204D126	D126	Ø 2.2	4	Ø 3.0	40	16	18.70	16.85	15.90	15.45	15.00
IK5502204D151	D151	Ø 2.2	4	Ø 3.0	40	16	18.70	16.85	15.90	15.45	15.00
IK5502504D91	D91	Ø 2.5	4	Ø 3.0	40	16	18.70	16.85	15.90	15.45	15.00
IK5502504D126	D126	Ø 2.5	4	Ø 3.0	40	16	18.70	16.85	15.90	15.45	15.00
IK5502504D151	D151	Ø 2.5	4	Ø 3.0	40	16	18.70	16.85	15.90	15.45	15.00
IK5503005D91	D91	Ø 3.0	5	Ø 3.0	75	15	30.95	27.90	26.35	25.55	24.80

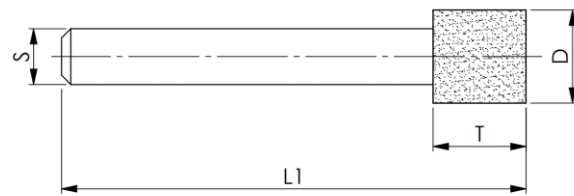
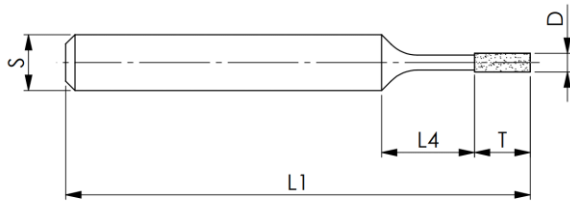

gedruckt am **07.03.2025**
gültig bis Widerruf

Diamant-Schleifstifte Typ 55 mit Hartmetall-Schaft

Abmessungen in mm
PL201.06

WMC Produktcode	Korn	Kopf-Ø D	Länge T	Schaft-Ø S	Länge L1	Länge L4	Preis pro Stück (CHF)				
							ab 1	ab 10	ab 25	ab 50	ab 100
IK5503005D126	D126	Ø 3.0	5	Ø 3.0	75	15	30.95	27.90	26.35	25.55	24.80
IK5503005D151	D151	Ø 3.0	5	Ø 3.0	75	15	30.95	27.90	26.35	25.55	24.80
IK5503205D91	D91	Ø 3.2	5	Ø 3.0	75		30.25	27.25	25.75	25.00	24.20
IK5503305D126	D126	Ø 3.3	5	Ø 3.0	75		30.25	27.25	25.75	25.00	24.20
IK5503405D151	D151	Ø 3.4	5	Ø 3.0	75		30.25	27.25	25.75	25.00	24.20
IK5503505D91	D91	Ø 3.5	5	Ø 3.0	75		45.90	41.35	39.05	37.90	36.75
IK5503505D126	D126	Ø 3.5	5	Ø 3.0	75		45.90	41.35	39.05	37.90	36.75
IK5503505D151	D151	Ø 3.5	5	Ø 3.0	75		45.90	41.35	39.05	37.90	36.75
IK5504005D91	D91	Ø 4.0	5	Ø 3.0	75		49.70	44.75	42.25	41.05	39.80
IK5504005D126	D126	Ø 4.0	5	Ø 3.0	75		49.70	44.75	42.25	41.05	39.80
IK5504005D151	D151	Ø 4.0	5	Ø 3.0	75		49.70	44.75	42.25	41.05	39.80
IK5504205D91	D91	Ø 4.2	5	Ø 4.0	75		37.60	33.85	32.00	31.05	30.10
IK5504305D126	D126	Ø 4.3	5	Ø 4.0	75		37.60	33.85	32.00	31.05	30.10
IK5504405D151	D151	Ø 4.4	5	Ø 4.0	75		37.60	33.85	32.00	31.05	30.10
IK5504505D91	D91	Ø 4.5	5	Ø 3.0	75		53.45	48.15	45.45	44.10	42.80
IK5504505D126	D126	Ø 4.5	5	Ø 3.0	75		53.45	48.15	45.45	44.10	42.80
IK5504505D151	D151	Ø 4.5	5	Ø 3.0	75		53.45	48.15	45.45	44.10	42.80
IK5505005D91	D91	Ø 5.0	5	Ø 3.0	75		54.70	49.25	46.50	45.15	43.80
IK5505005D126	D126	Ø 5.0	5	Ø 3.0	75		54.70	49.25	46.50	45.15	43.80
IK5505005D151	D151	Ø 5.0	5	Ø 3.0	75		54.70	49.25	46.50	45.15	43.80
IK5506006D91	D91	Ø 6.0	6	Ø 6.0	100	36	57.95	52.20	49.30	47.85	46.40
IK5506006D126	D126	Ø 6.0	6	Ø 6.0	100	36	57.95	52.20	49.30	47.85	46.40
IK5506006D151	D151	Ø 6.0	6	Ø 6.0	100	36	57.95	52.20	49.30	47.85	46.40
IK5506206D91	D91	Ø 6.2	6	Ø 6.0	100		50.20	45.20	42.70	41.45	40.20
IK5506306D126	D126	Ø 6.3	6	Ø 6.0	100		50.20	45.20	42.70	41.45	40.20
IK5506406D151	D151	Ø 6.4	6	Ø 6.0	100		50.20	45.20	42.70	41.45	40.20
IK5507008D91	D91	Ø 7.0	8	Ø 6.0	100		80.65	72.60	68.60	66.55	64.55
IK5507008D126	D126	Ø 7.0	8	Ø 6.0	100		80.65	72.60	68.60	66.55	64.55
IK5507008D151	D151	Ø 7.0	8	Ø 6.0	100		80.65	72.60	68.60	66.55	64.55
IK5508008D91	D91	Ø 8.0	8	Ø 6.0	100		80.65	72.60	68.60	66.55	64.55
IK5508008D126	D126	Ø 8.0	8	Ø 6.0	100		80.65	72.60	68.60	66.55	64.55
IK5508008D151	D151	Ø 8.0	8	Ø 6.0	100		80.65	72.60	68.60	66.55	64.55
IK5508208D91	D91	Ø 8.2	8	Ø 8.0	100		77.60	69.85	66.00	64.05	62.10
IK5508308D126	D126	Ø 8.3	8	Ø 8.0	100		77.60	69.85	66.00	64.05	62.10
IK5508408D151	D151	Ø 8.4	8	Ø 8.0	100		77.60	69.85	66.00	64.05	62.10
IK5510010D91	D91	Ø 10.0	10	Ø 8.0	100		104.20	93.80	88.60	86.00	83.40
IK5510010D126	D126	Ø 10.0	10	Ø 8.0	100		104.20	93.80	88.60	86.00	83.40
IK5510010D151	D151	Ø 10.0	10	Ø 8.0	100		104.20	93.80	88.60	86.00	83.40
IK5510210D91	D91	Ø 10.2	10	Ø 10.0	110		99.90	89.95	84.95	82.45	79.95
IK5510310D126	D126	Ø 10.3	10	Ø 10.0	110		99.90	89.95	84.95	82.45	79.95
IK5510410D151	D151	Ø 10.4	10	Ø 10.0	110		99.90	89.95	84.95	82.45	79.95
IK5512010D91	D91	Ø 12.0	10	Ø 10.0	110		114.30	102.90	97.20	94.30	91.45

Diamant-Schleifstifte Typ 55 mit Hartmetall-Schaft

Abmessungen in mm
PL201.06

WMC Produktcode	Korn	Kopf-Ø D	Länge T	Schaft-Ø S	Länge L1	Länge L4	Preis pro Stück (CHF)				
							ab 1	ab 10	ab 25	ab 50	ab 100
IK5512010D126	D126	Ø 12.0	10	Ø 10.0	110		114.30	102.90	97.20	94.30	91.45
IK5512010D151	D151	Ø 12.0	10	Ø 10.0	110		114.30	102.90	97.20	94.30	91.45
IK5513010D91	D91	Ø 13.0	10	Ø 10.0	110		120.40	108.40	102.35	99.35	96.35
IK5513010D126	D126	Ø 13.0	10	Ø 10.0	110		120.40	108.40	102.35	99.35	96.35
IK5513010D151	D151	Ø 13.0	10	Ø 10.0	110		120.40	108.40	102.35	99.35	96.35
IK5514010D91	D91	Ø 14.0	10	Ø 10.0	110		128.50	115.65	109.25	106.05	102.80
IK5514010D126	D126	Ø 14.0	10	Ø 10.0	110		128.50	115.65	109.25	106.05	102.80
IK5514010D151	D151	Ø 14.0	10	Ø 10.0	110		128.50	115.65	109.25	106.05	102.80
IK5515010D91	D91	Ø 15.0	10	Ø 10.0	110		132.85	119.60	112.95	109.65	106.30
IK5515010D126	D126	Ø 15.0	10	Ø 10.0	110		132.85	119.60	112.95	109.65	106.30
IK5515010D151	D151	Ø 15.0	10	Ø 10.0	110		132.85	119.60	112.95	109.65	106.30

Lieferfrist: ab Werklager 1 - 2 Arbeitswochen, Zwischenverkauf vorbehalten